

See Map 19

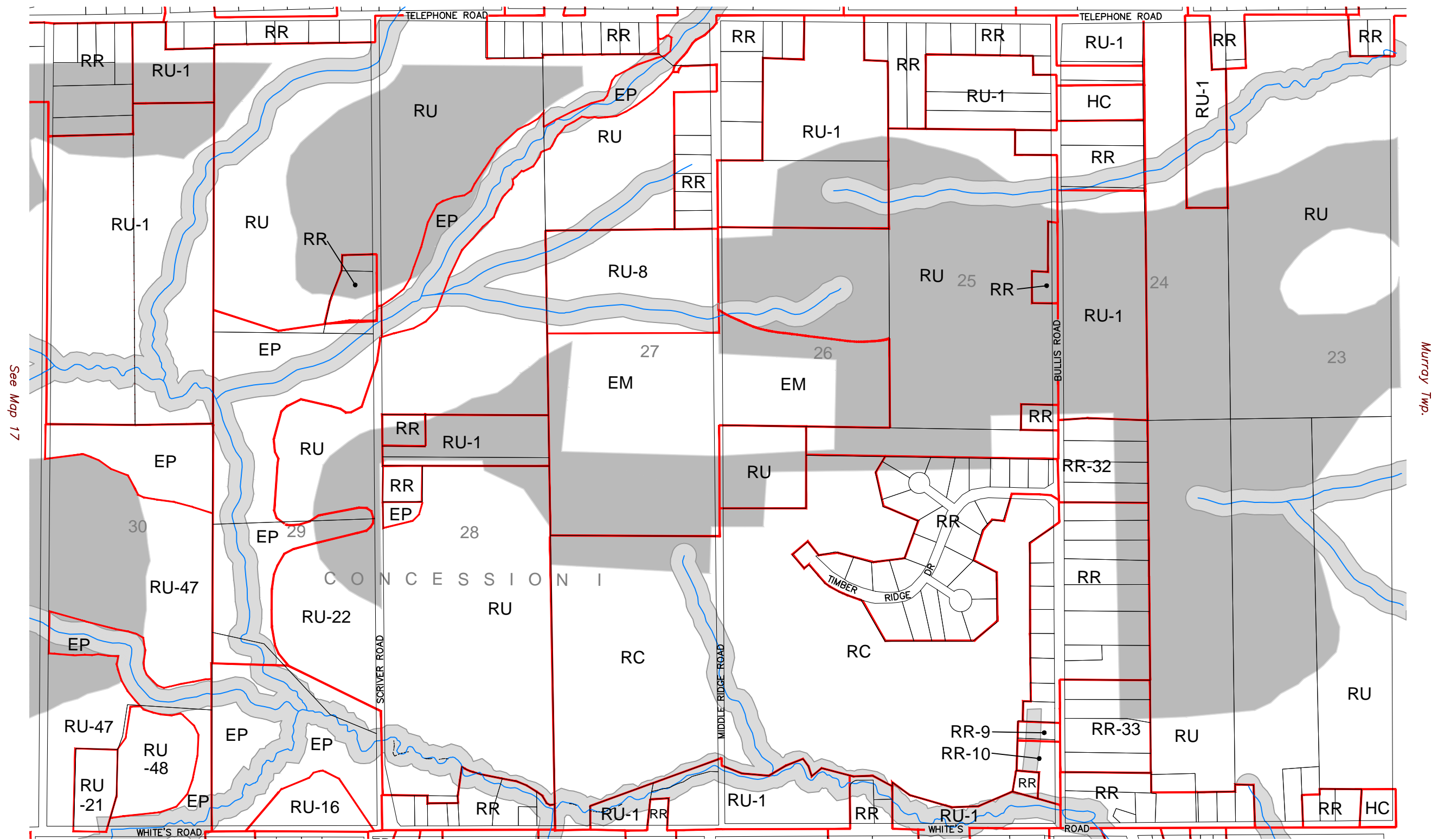

See Map 17

See Map 13

**LEGEND**

|     |                              |    |                               |       |                                      |
|-----|------------------------------|----|-------------------------------|-------|--------------------------------------|
| R1  | URBAN RESIDENTIAL ONE ZONE   | RC | RECREATIONAL COMMERCIAL ZONE  | FD    | FUTURE DEVELOPMENT ZONE              |
| R2  | URBAN RESIDENTIAL TWO ZONE   | M1 | GENERAL INDUSTRIAL ZONE       |       | FLOODPLAIN AREA ZONE                 |
| R3  | URBAN RESIDENTIAL THREE ZONE | M2 | RURAL INDUSTRIAL ZONE         |       | FLOODPRONE AREA ZONE                 |
| RR  | RURAL RESIDENTIAL ZONE       | EM | EXTRACTIVE INDUSTRIAL ZONE    |       | RESOURCE RESERVE AREA ZONE           |
| HR  | HAMLET RESIDENTIAL ZONE      | RU | RURAL ZONE                    | H     | HOLDING ZONE                         |
| SHR | SHORELINE RESIDENTIAL ZONE   | A  | AGRICULTURAL ZONE             | U     | WAVE UPRUSH REQUIREMENT              |
| LC  | LOCAL COMMERCIAL ZONE        | OS | OPEN SPACE ZONE               | F ( ) | FLOOD PROOFING ELEVATION REQUIREMENT |
| CA  | CORE AREA ZONE               | CF | COMMUNITY FACILITY ZONE       |       |                                      |
| HC  | HIGHWAY COMMERCIAL ZONE      | EP | ENVIRONMENTAL PROTECTION ZONE |       |                                      |



**Municipality of Brighton Zoning By-Law**  
**SCHEDULE A MAP 16**